

## *Vivere sotterraneo*

# STAR WARS





*Guerre stellari*  
Episodio IV, *Una nuova speranza*, (1977)







Matmata

(ممي دقلا ةطامطم) *Maṭmāṭat-al-Qadīmah*







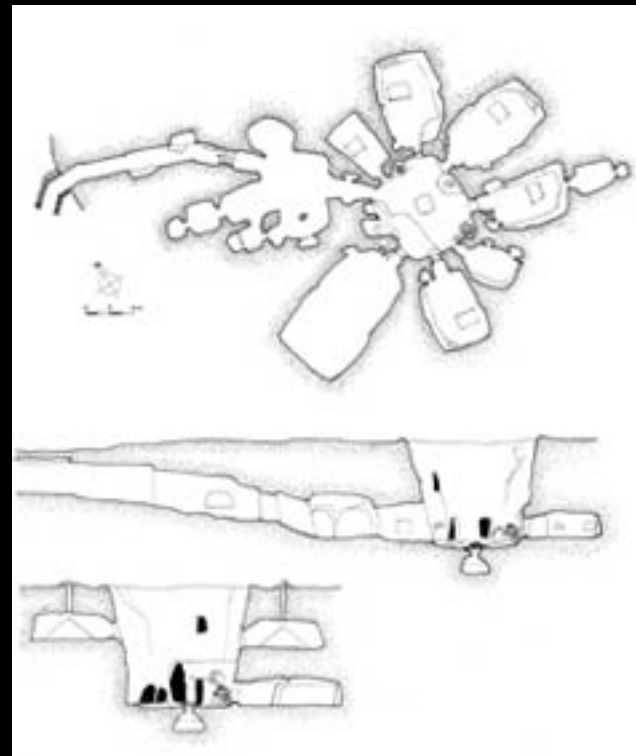
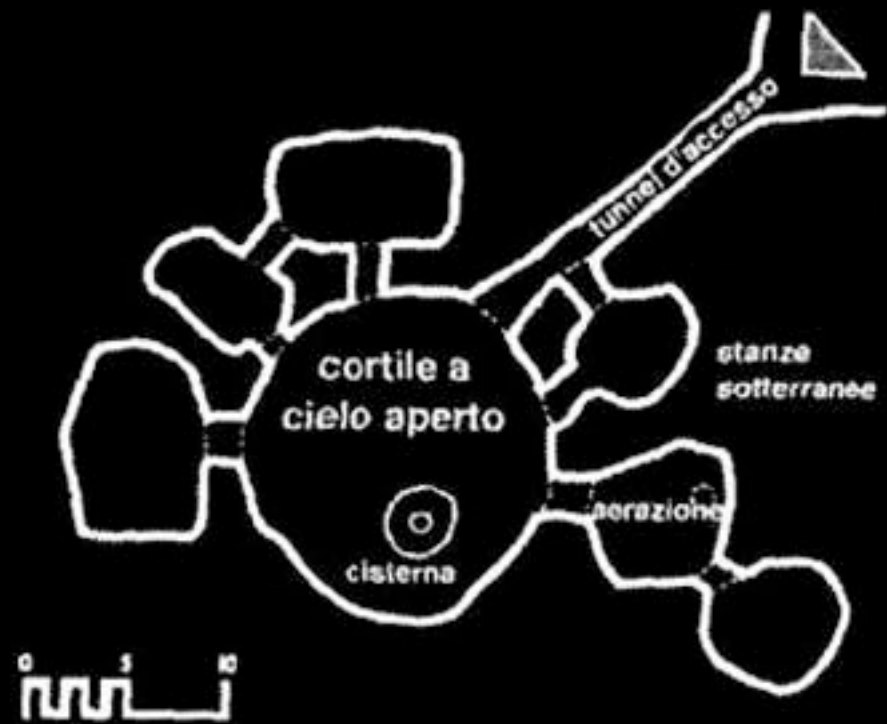



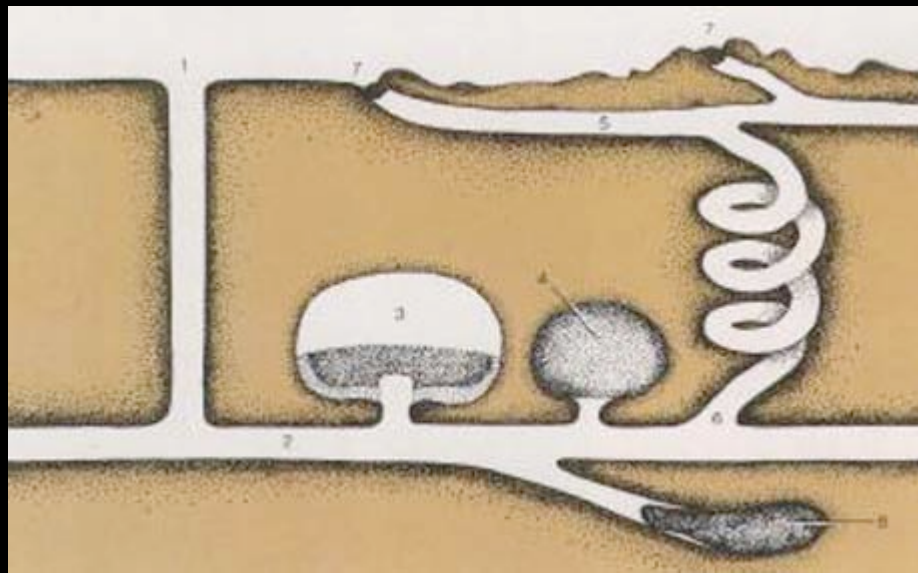





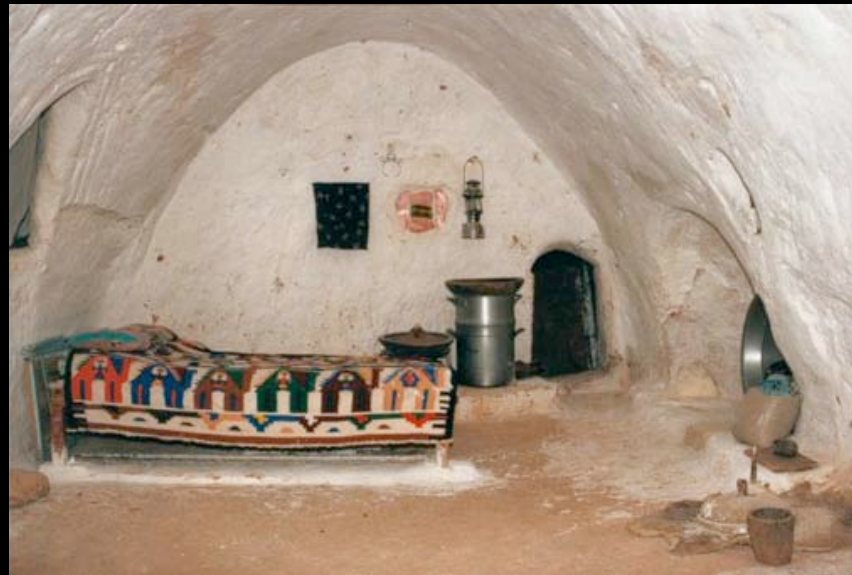





*matmata*



*in attesa del cielo*

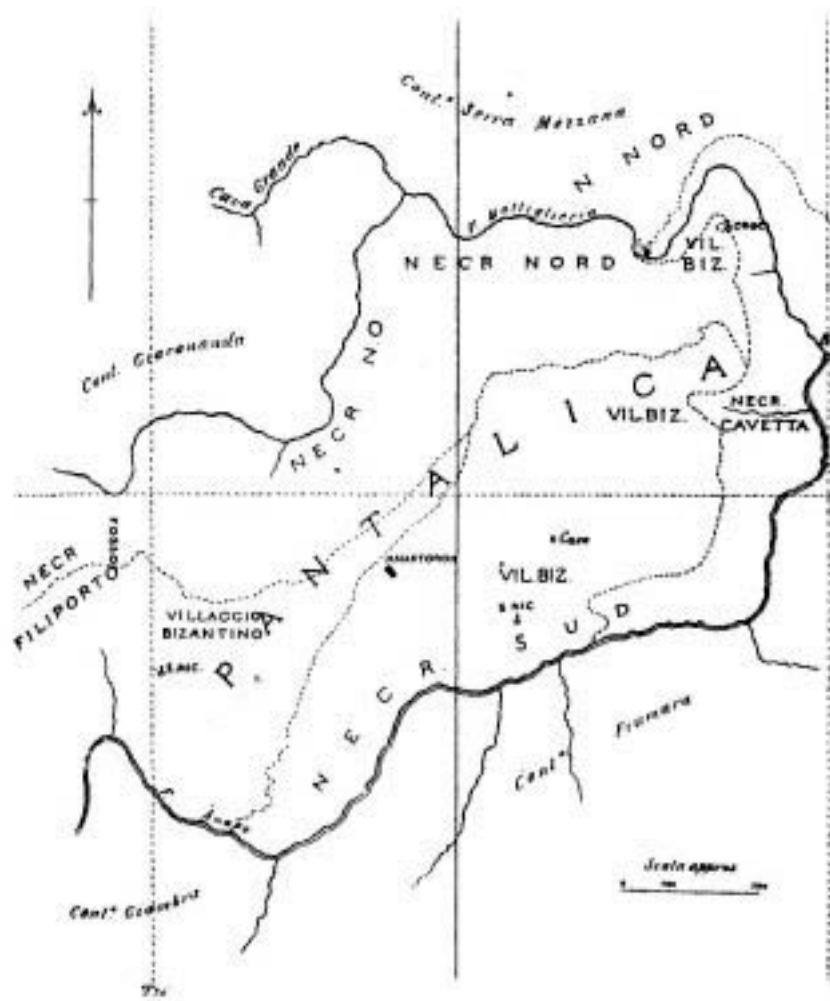

Pantalica











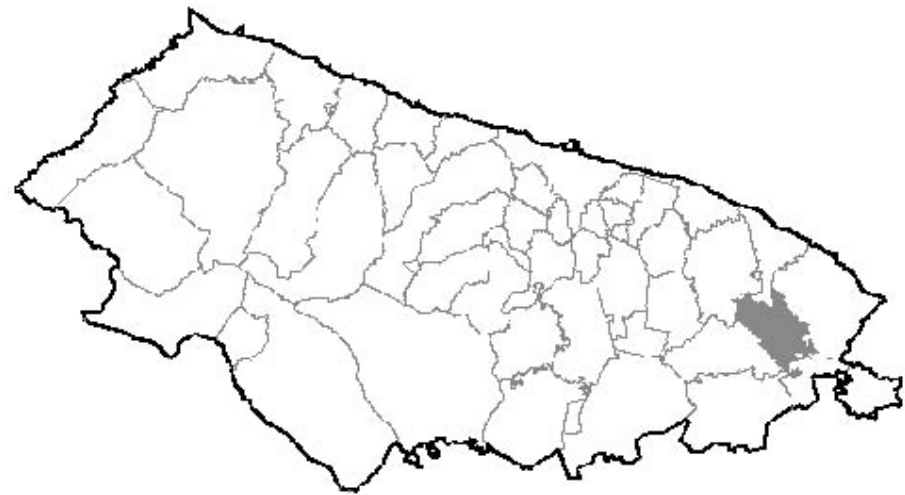

**Grotte di Castellana**







## ***La cappella sistina del paleolitico***

*Marcel Ravidat, Jacques Marsal, Georges Agnel e Simon Coencas\_12 settembre 1940*





# Grotta di Lascaux

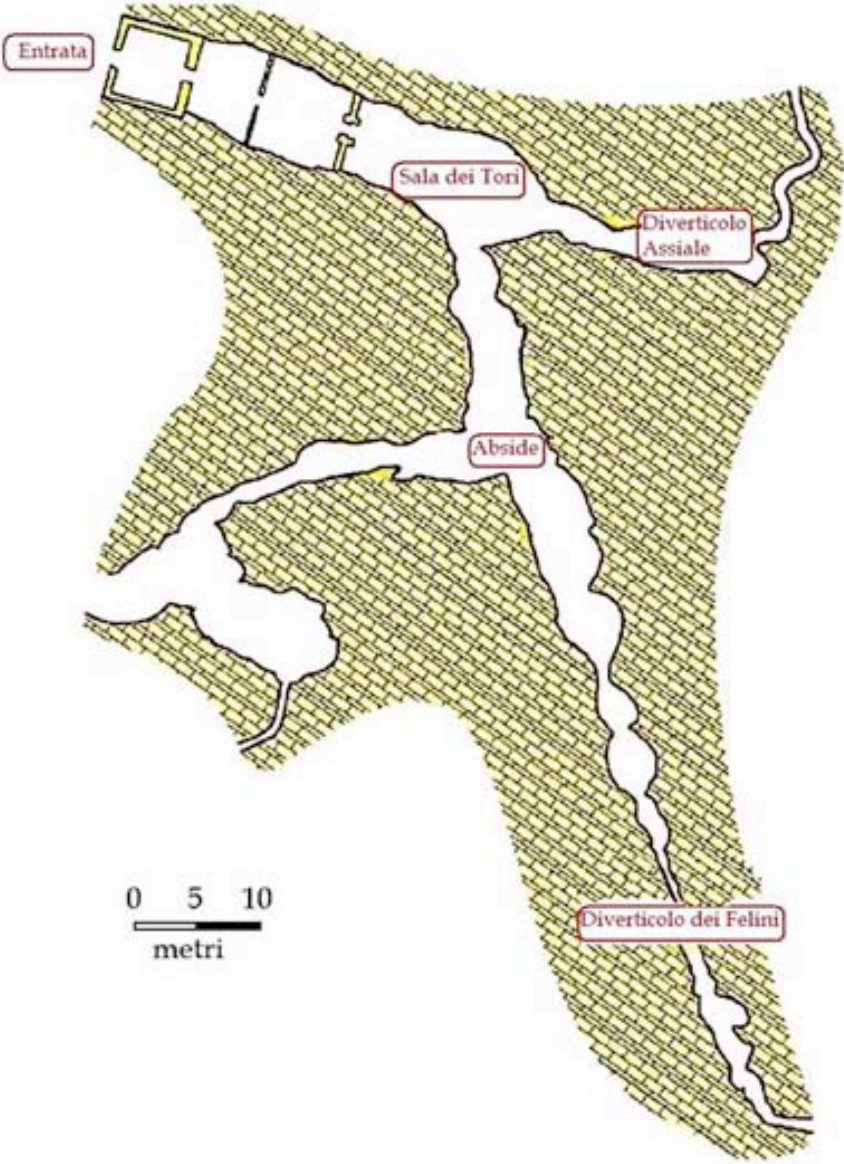





### Grotta di Lascaux

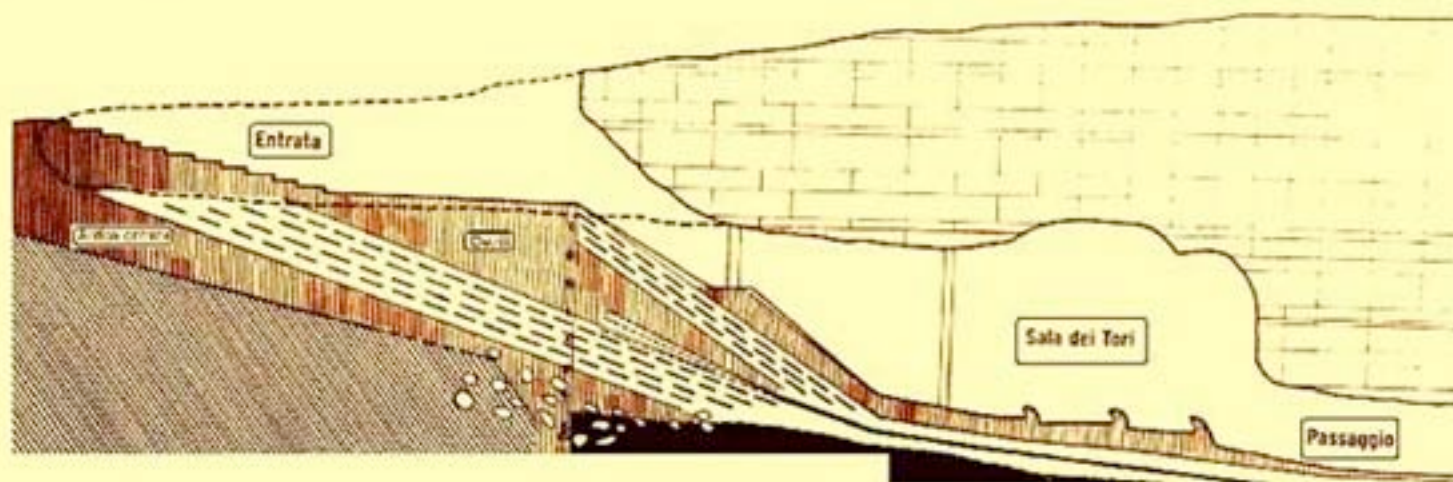

0 5 10  
metri

Asse della Grotta

311°



$\delta = +\epsilon$

Tramonto del Sole al  
solstizio d'estate

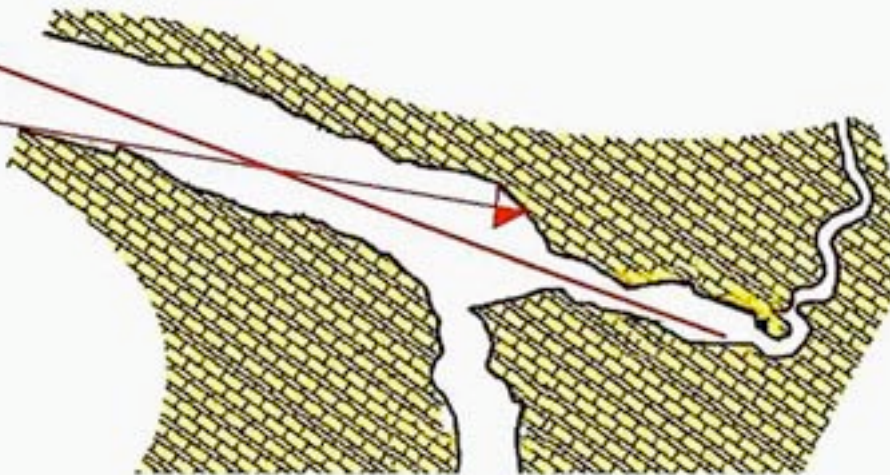





***Nell'esistenza di una città intervengono trasformazioni e distruzioni dei suoi edifici.  
Nella sua persistenza, la natura il carattere e l'espressività del suolo.  
L'architettura del suolo supera nella portata l'architettura degli edifici.  
L'architettura del suolo è sempre archetipa; l'architettura degli edifici è sovente  
legata agli stili.***

*Francesco Venezia*

Architettura Mediterranea  
XVII Triennale di Milano, 1987  
"Nove Viaggi in Nove Città"  
*Sottosuolo partenopeo e architettura ipogea greco romana*

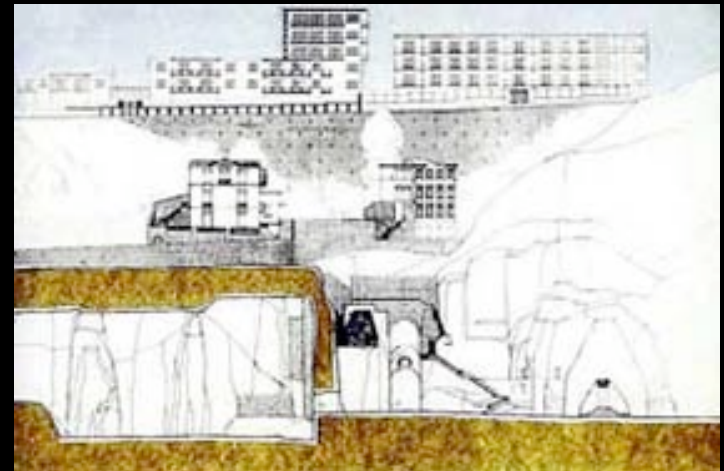



**Sibilla Cumana**  
*Andrea del Castagno*  
*Palazzo Carducci Pandolfini, Firenze, Affresco, 1450*



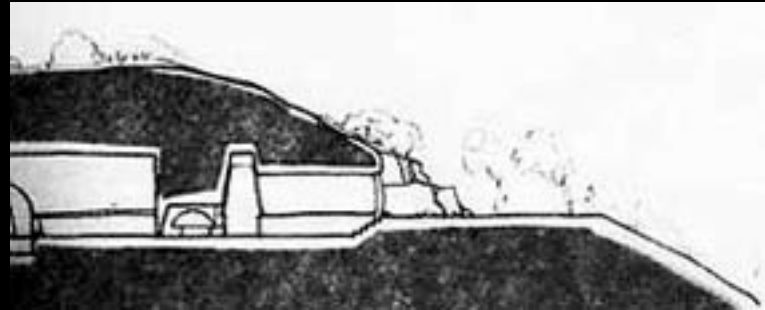







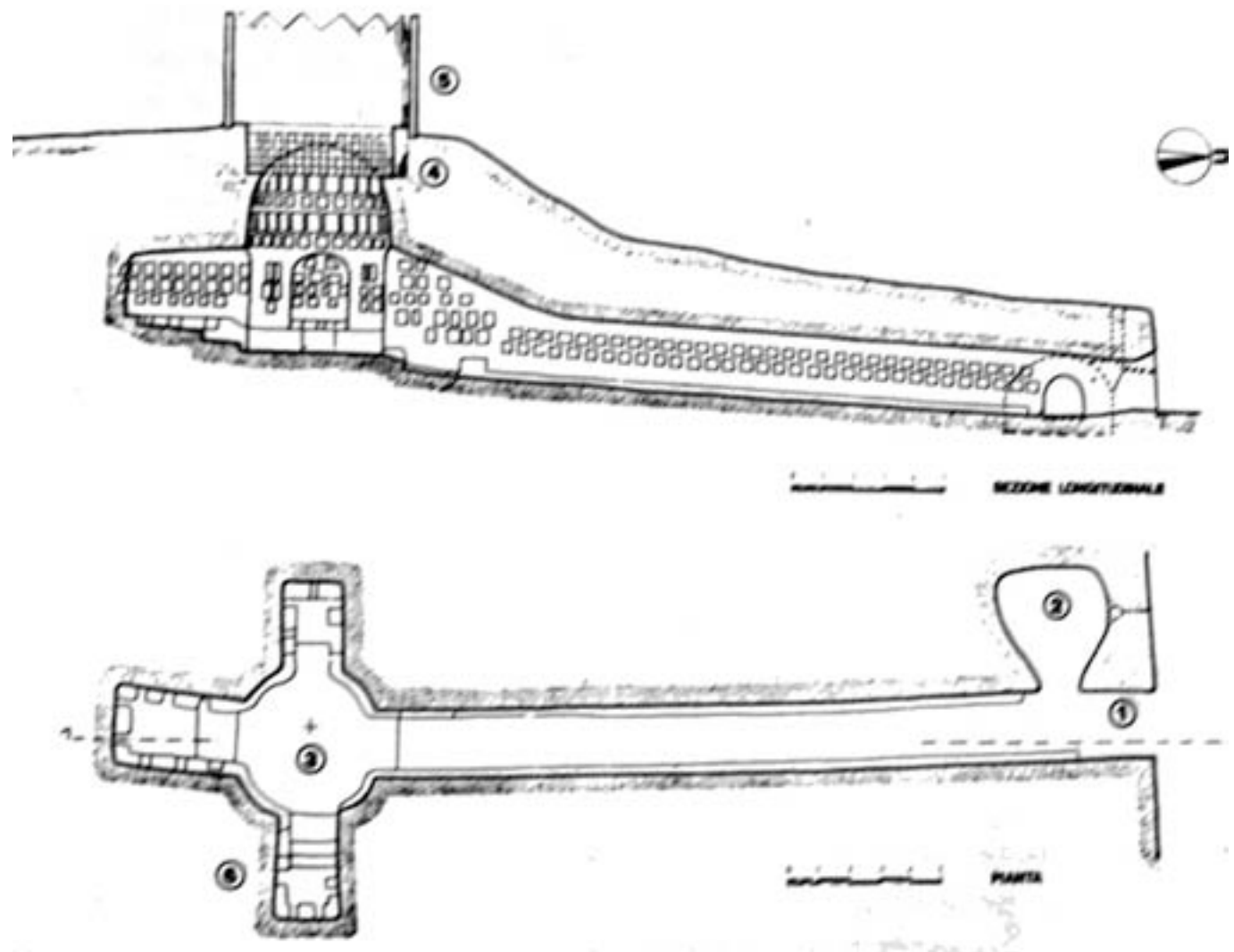

Torre Pinta













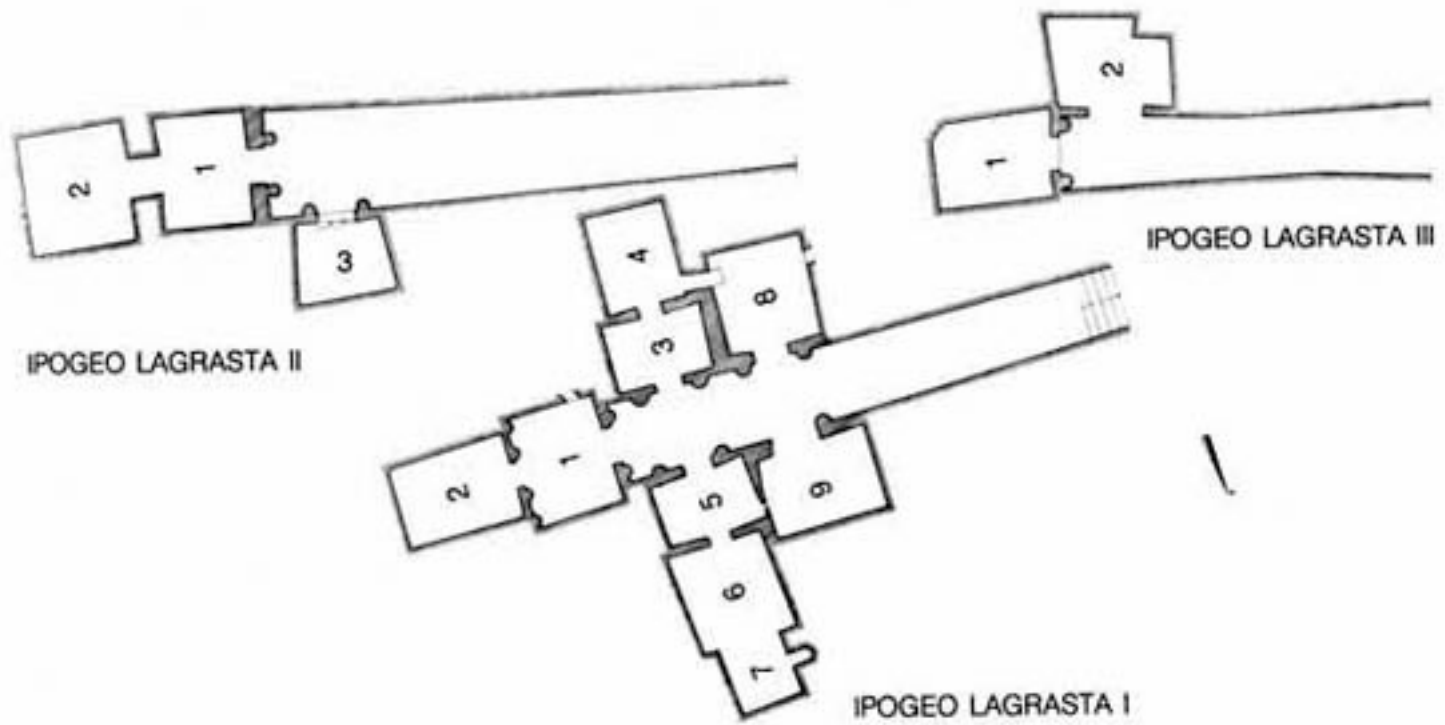

**Ipogeo Lagrasta**





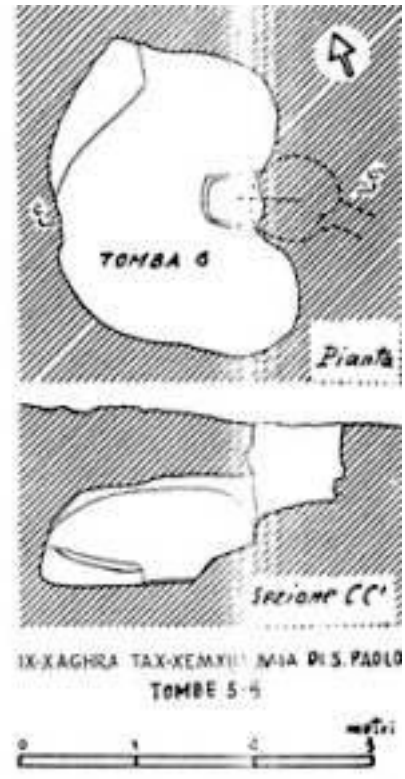
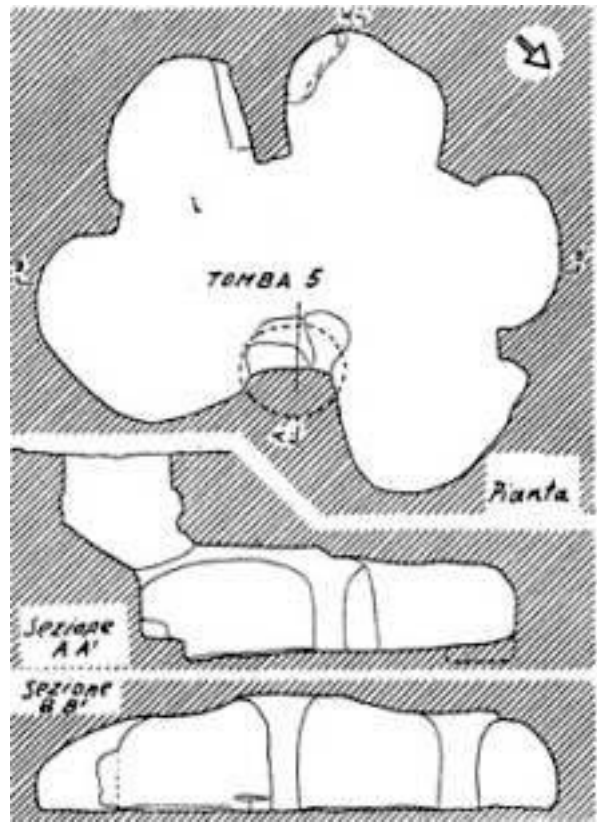

IX-XAGHRA TAX-KEMJI' MIA DI S. PAOLO  
 TOMBE 5-6  
 0 1 2 3 metri

Hal-Saflieni

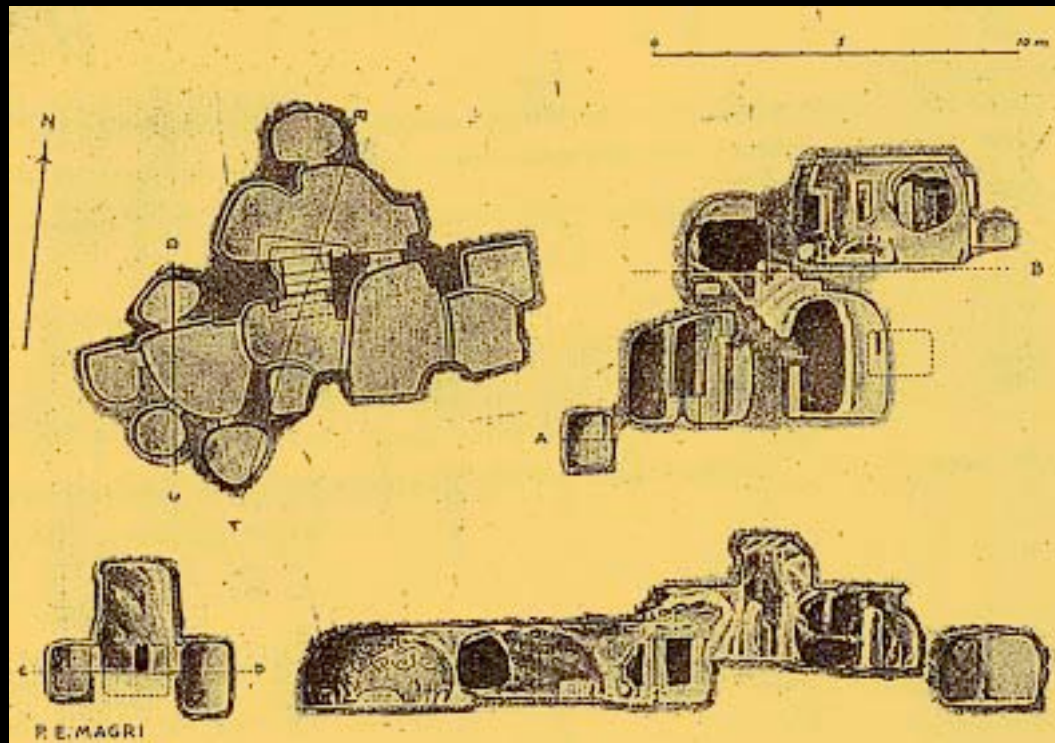













**Ortigia**









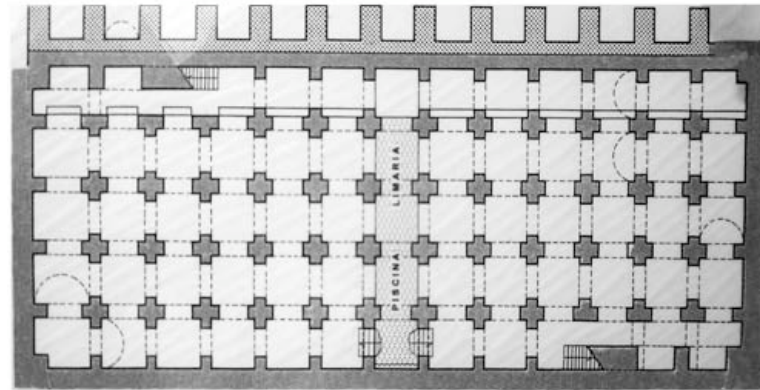

**Piscina Mirabilis**











**Yerebatan Sarayı**









# ASSASSIN'S CREED REVELATIONS



